

NOTES:

1. FABRICATE PER 3D DATA FILE HAVING THE SAME NUMBER AND REVISION AS SHOWN IN TITLE BLOCK.
2. ALL REFERENCED PHILIPS DOCUMENTS ARE INVOKED AT THEIR LATEST REVISION.
3. MATERIAL: MUSIC WIRE PER ASTM A228. $\triangle C$ PBWXT0065D4
4. FINISH: PHOSPHATE COATING $\triangle C$ → To use ER3 Blue zinc 10/9/19
5. REFERENCE: TORQUE AT 81° = 0.029 N-M $\triangle C$
6. PARTS TO BE FREE OF ALL BURRS AND SHARP EDGES.
7. ALL ITEMS DELIVERED IN ACCORDANCE WITH THIS SPECIFICATION SHALL COMPLY WITH THE PHILIPS REGULATED SUBSTANCES LIST (RSL) REQUIREMENTS AS STATED IN PHGR-GS-BP01-012 PHILIPS REGULATED SUBSTANCES LIST.

PHILIPS

THIS DOCUMENT AND THE INFORMATION CONTAINED IN IT IS PROPRIETARY AND CONFIDENTIAL INFORMATION OF PHILIPS HEALTHCARE, A DIVISION OF PHILIPS ELECTRONICS NORTH AMERICA CORPORATION ("PHILIPS"). USE, DUPLICATION, MODIFICATION, AND DISCLOSURE OF IT BY UNAUTHORIZED PERSONS IS STRICTLY PROHIBITED AND SUBJECT TO THE RESTRICTIONS, IF APPLICABLE, SET FORTH IN A CONFIDENTIALITY AGREEMENT WITH PHILIPS.

REV. C		DESCRIPTION
REV.	C	ADDED MATERIAL AND TORQUE REQUIREMENTS FOR MUSIC WIRE. ADDED ANGULAR REQUIREMENT FOR SPRING AT REST.

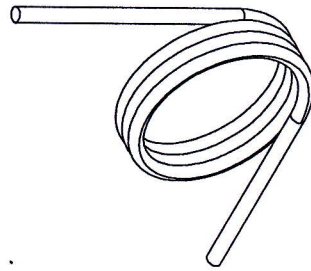
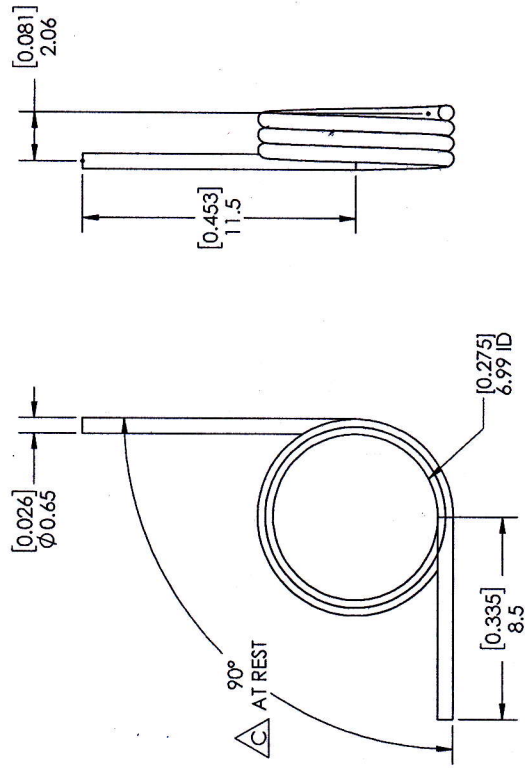

SCALE	5:1	PROJ. THIRD ANGLE	UNITS	MM	TOLERANCES UNLESS OTHERWISE STATED	GENERAL ROUGHNESS	ASME Y14.5 - 2009
					DIMENSIONS	3.2 um	
					X.X ± 0.25		
					ANGLE		
					± 0.5°		
DATE		6/7/2019		Author		Domenico Galeotalanza	
DRAWING NUMBER				453562011290001			
PART NUMBER				453562011291			
LANGUAGE				ENGLISH			
SHEET				1 OF 1			
SHEETS				1			
SIZE				B			

SPRING, TOGGLE ARM, TRANSDUCER