

FOR REFERENCE ONLY IF PRINTED	DRAWING STATUS:
CAD DATABASE FILENAME: WHIP	

REV.	DESCRIPTION.	DATE.	ECO NO.	BY.
1	Released for Prototype.	02-Apr-19	N/A	KY Ho

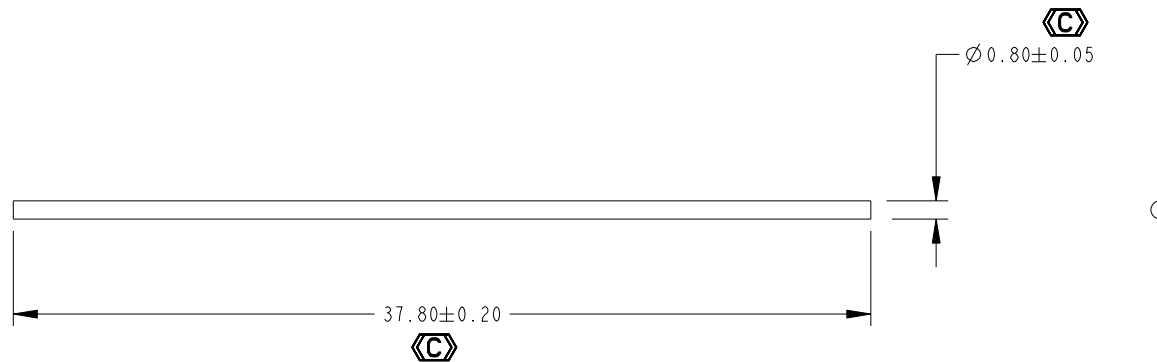

SCALE 3.000

NOTES:

- MATERIAL :  $\varnothing 0.8\text{mm}$  MUSIC WIRE
- PLATING: COPPER PLATED  
THICKNESS: 6 TO 12 MICRON
- ALL DIMENSIONS ARE IN MILLIMETERS
- CAD CONTROLLED GEOMETRY
- MAX BURR 0.05MM. NO LOOSE BURRS PERMITTED
- PARTS SHALL BE FREE OF LOOSE BURRS, OILS AND DEBRIS.
- NO CHANGE IN MATERIAL AND SHEET THICKNESS IS ALLOWED WITHOUT PRIOR WRITTEN APPROVAL BY EMITS TECHNOLOGY.
- DO NOT SCALE DRAWING.
- PARTS SHALL BE PACKAGED IN A MANNER TO PREVENT BOWING, SCRATCHING OR DAMAGE DURING SHIPMENT (FOR EXAMPLE USE TRAY).
- DIMENSIONS TO THEORETICAL INTERSECTION (TTI).
- ALL MATERIALS, PLATING AND PROCESSES USED TO FABRICATE THE COMPONENT SPECIFIED ON THIS DOCUMENT MUST COMPLY WITH THE RoHS DIRECTIVE 2002/95EC AND GP SS-00259 REQUIREMENTS.

ITEM NO.	QTY.	PART NUMBER	DESCRIPTION	MATERIAL
EMITS PROPRIETARY - THE DRAWING ON THIS PRINT AND INFORMATION THEREWITH ARE PROPRIETARY TO EMITS, AND SHALL NOT BE DISCUSS IN WHOLE OR IN PART WITHOUT EMITS CONCENT.				
TOLERANCES (UNLESS SPECIFIED): X $\pm 1.0$ X.X $\pm 0.5$ X.XX $\pm 0.05$ ANGLES $\pm 1^\circ$ CONCENTRICITY $\pm 0.05$ PERPENDICULARITY $\pm 0.05$ FLATNESS $\pm 0.05$ BREAK ALL CORNERS R0.25 MAX 		METRIC UNITS = mm MATERIAL: See Notes <b><i>emits Technology Sdn. Bhd.</i></b> No.2, Lorong Dahlia, Tmn Industri Dahlia, Mak Mandin 13400 Butterworth, Penang, Malaysia.		
INDICATES CRITICAL DIMENSION INDICATES SPC REQUIRED Cpk < 1.5 REQUIRES CORRECTIVE ACTION DIMENSIONING AND TOLERANCING PER ASME Y14.5M-1994		DRAWN: KY Ho CHECKED: KY Ho APPROVED: BL Loy FINISH: See Notes		<b>Whip 350-400MHz, PD790</b> <b>A4</b> SIZE
PROJECT DATABASE LOCATION:		SCALE: 2.000	REV. 1	PART NUMBER: <b>SPR301904289</b> PAGE: 1 OF 1